

**County Road 378 Project: CR687 N to Bangor City Limits**  
Boundary and Topographical Surveying and Design Engineering Services

**Addendum #1 to Request for Proposals**

The Request for Proposals has been modified ONLY as follows. Except where noted herein, the Proposal shall remain the same.

**1. Statement of Work / Specifications**

The "Attachment" referenced in the Statement of Work/Specifications was inadvertently omitted from the original Request for Proposal. It is now attached to this Addendum.

**VAN BUREN COUNTY ROAD COMMISSION**

DC/jb

# BANGOR TOWNSHIP



0' 2640' 5280'  
1-1/2" = 5280'

TOWNSHIP: BANGOR, T. 2S, R. 16W  
COUNTY: VAN BUREN

PRIMARY: 18.50 MILES  
LOCAL: 61.55 MILES

## LEGEND

INTERSTATE  
STATE TRUNKLINE  
CITY OR VILLAGE STREET  
CORPORATE LIMITS

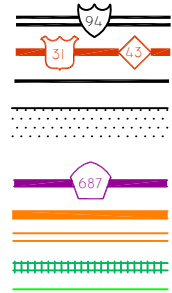

COUNTY PRIMARY  
COUNTY LOCAL (PAVED)  
COUNTY LOCAL (GRAVEL)  
ADJACENT COUNTY  
RAILROAD

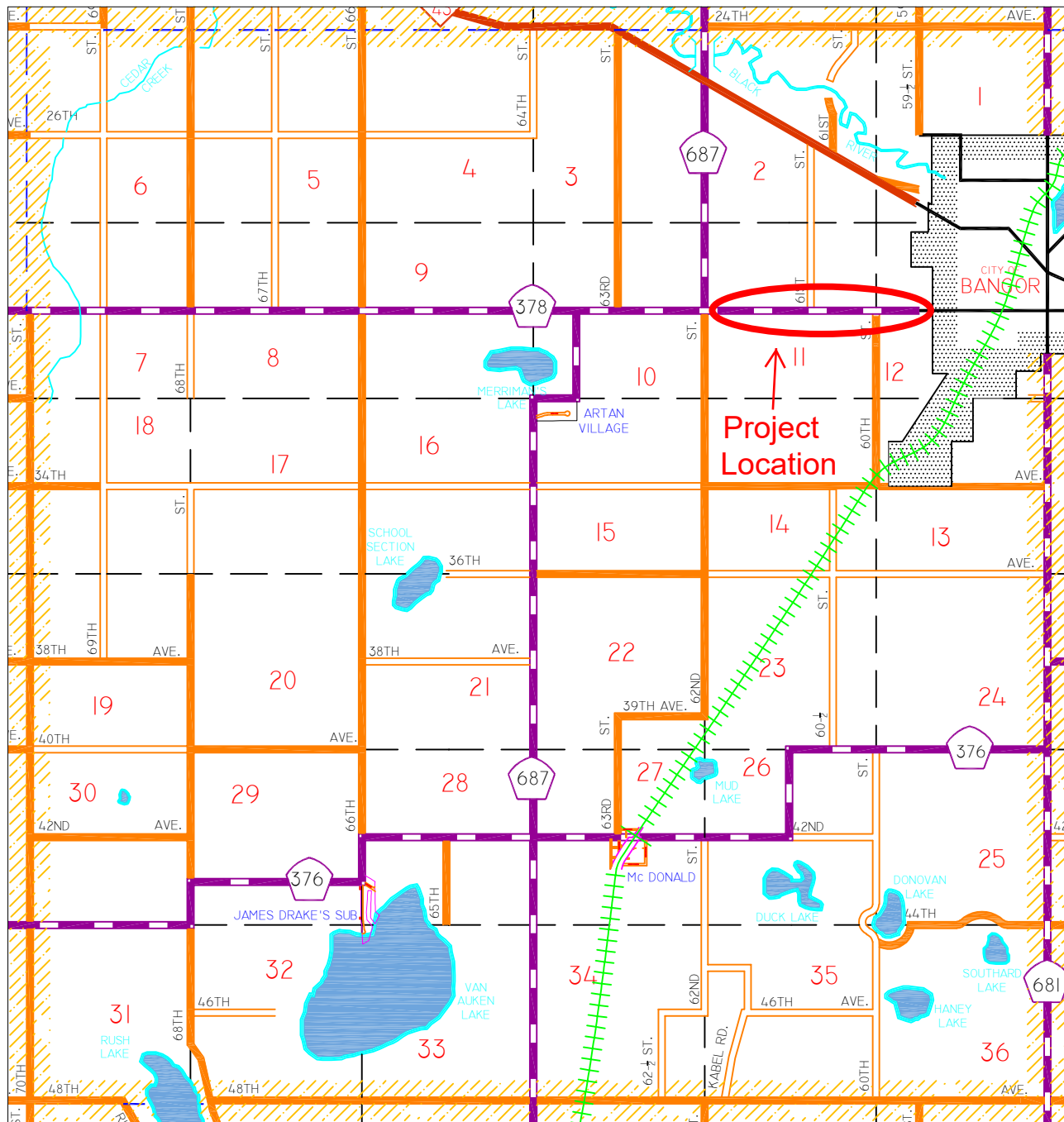

## BANGOR TOWNSHIP

DATE CERTIFIED:	DRAFTSMAN: D. STICKELS
NOTES:	DRAFTSMAN: E.M. JONES
REVISED: 10/2006	DRAWING NUMBER 80-9